

How To Create a Moody Skyline Using Bleachable Ink



Get Started What You'll Need



PD342
BL-Ink

BR930A...
Student Flat Synthetic
Short Handled Brushes



DP866A...
Sakura Pen-Touch
Metallic Markers



DP407C
Spectrum Technical
Pen Set



PB051...
Spectrum Artist Watercolour
Paper Pads

BR480A999
Artist Synthetic
Detail Brush Set



Step by Step

LET'S CREATE



1 Prepare your workspace. You will need a range of brushes, including small detail brushes, masking tape and either bleach or sterilising fluid, as well as bleachable BL-ink.



2 Using masking tape, tape down the edges of your paper if you're not using a sketch pad. Using a thick brush, wet your paper.



3 Before letting the water dry, brush on a layer of BL-ink.

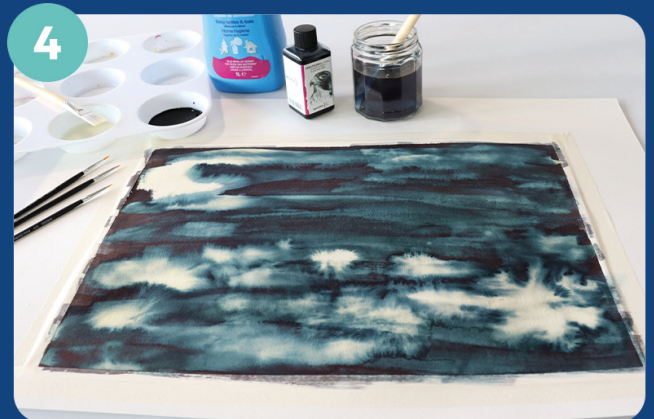

4 Next, whilst the ink is still wet, brush on your bleach or sterilising fluid using a thick brush and watch the magic happen. You will start to see the blue and cream undertones of the ink appear and react with the bleach.



5 Once this layer is dry, using a flat brush, paint the outline of your skyline along the bottom of the paper using BL-ink.



6 Next, using a fineliner or technical pen, draw on the details of your buildings such as chimneys, spires and rooftops.

Step by Step

LET'S CREATE

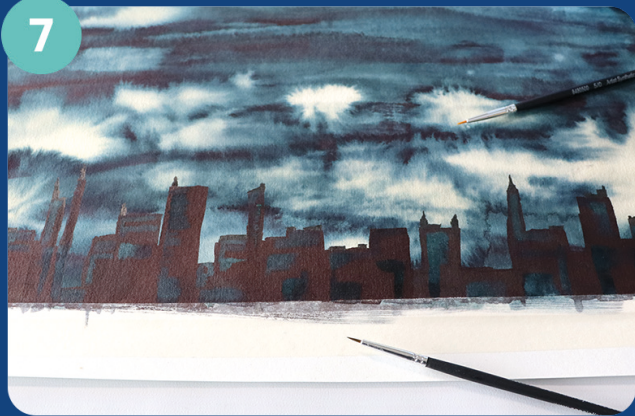

With a thin detail brush, paint on more bleach or sterilising fluid to remove areas of highlight and detailing of your buildings.



Next, if this isn't enough detail you can use a pen-touch marker in silver or white to add more highlights and details such as windows and reflections. Your pen may not work as well over areas the bleach has been applied to.

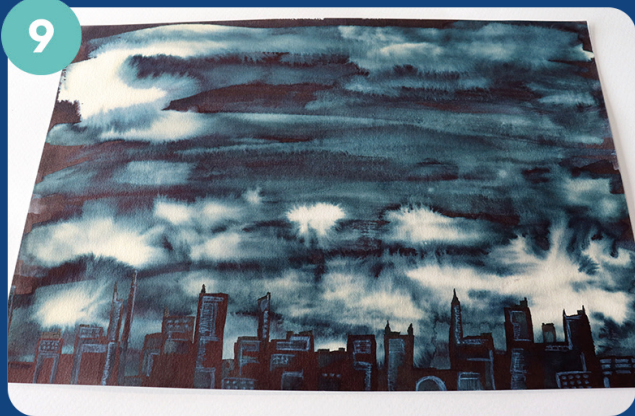

Once your pen and ink is dry your moody skyline is finished!